

## Designer Series

**1 Story**  
**3 Bedrooms**  
**3 Bathrooms**  
**3 Car Garage**

## OPEN LAYOUT WITH GREAT OUTDOOR SPACE

The Live Oak home design is ideal for waterfront living. The floor plan offers spacious open concept with a 90 degree slider that connects the lanai with the indoor living space. Great for entertaining and relaxing.



Living Space: 2397 SF  
Garage: 653 SF  
Lanai: 200 SF  
Entry: 104 SF

---

**Total: 3354 SF**

## Features

The Live Oak features a large, open floor plan. 90 Degree slider off dining room allows you to truly connect to the lanai while entertaining. Bath 2 can function as a pool bath. Kitchen features a double wall oven and cooktop with hood. Spacious walk through shower and freestanding tub in Master Bath.

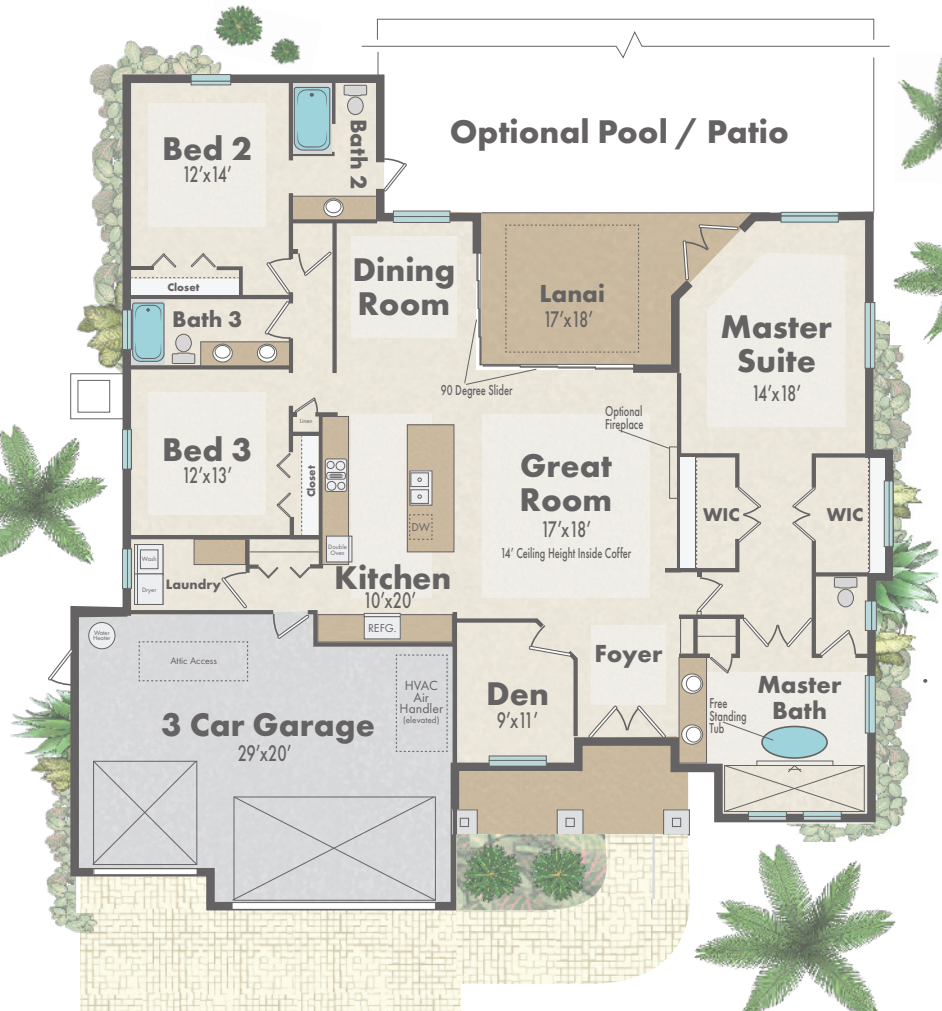

*\* Floorplans are artistic depictions and may be shown with optional features*

*\* Square footage and room sizes are approximate and may vary in construction*